

- * USE 4" WHEN 2' TO 3' LONG
- * SIDEWALK ONLY

TYPE I BARRICADE

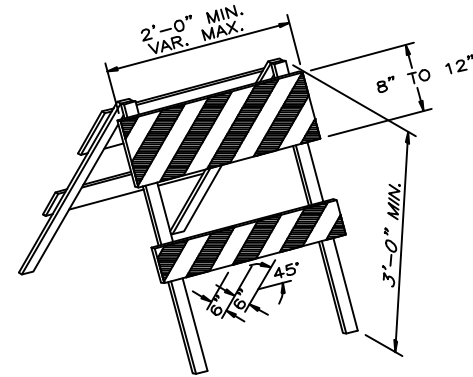

- * USE 4" WHEN 2' TO 3' LONG
- * SIDEWALK ONLY

TYPE I BARRICADE

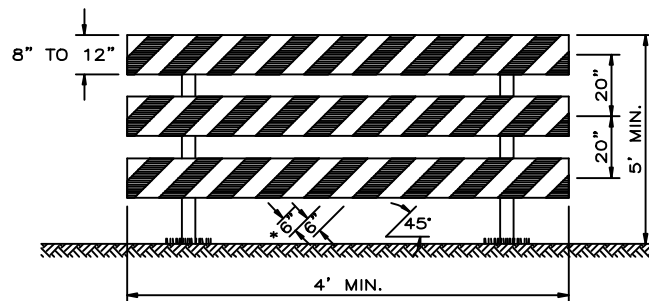

- * USE 4" WHEN 2' TO 3' LONG

TYPE III BARRICADE

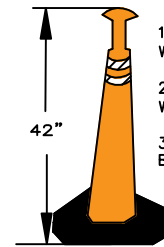

1. 42" GRABBER CONE W/REFLECTIVE COLLAR. OR
2. 42" GRABBER TUBE W/REFLECTIVE STRIPES.
3. BOTH WITH 12# RUBBER BASE.



1. CHANNELIZER DRUM W/REFLECTIVE STRIPES.
2. 25 # OR 45 # BASE.
3. LOW/HIGH DENSITY POLYETHYLENE FOR REPEATED IMPACTS.

TYPE II BARRICADE

NOTES:

1. FLASHING OR STEADY BURN WARNING LIGHTS SHOULD BE USED ON BARRICADES AS NEEDED.
2. ALL BARRICADES MUST CONFORM TO OHIO MANUAL OF UNIFORM TRAFFIC CONTROL DEVICES.

STANDARD BARRICADE TYPES